

Pivoting Spinning Wheel Blasters

SPECIFICATION: Chain Conveyor

- Swing Clearance Zone R10.5
- Nozzle GPM – 1.5 or 2.0 gpm
- 8 Laser Nozzles
- Height 24.5
- Depth 19.0
- Width 20.00

SUPPORT EQUIPMENT/PARTS NEEDED TO INSTALL

- 1) Car Wash Controller
- 2) Air Compressor (2 CFM)
- 3) 1/4 " Modular Filter, Regulator, Lubricator (FRL) (70 PSI Operating Pressure)
- 4) Activation by Treadle or Photo Eye
- 5) High Pressure Pump Station, 20 gpm, 1000 psi

MOUNTING REQUIREMENTS

- 1) 24" X 24" X 24" Area
- 2) Bolt pattern 10" x 6" (see page 1 for details)

THE INFORMATION CONTAINED IN THIS DRAWING IS THE SOLE PROPERTY OF THE COBRA SYSTEM. ANY REPRODUCTION IN PART OR WHOLE WITHOUT THE WRITTEN PERMISSION OF THE COBRA SYSTEM IS PROHIBITED.

4/30/23



REVISIONS			
REV.	DESCRIPTION	DATE	APPROVED

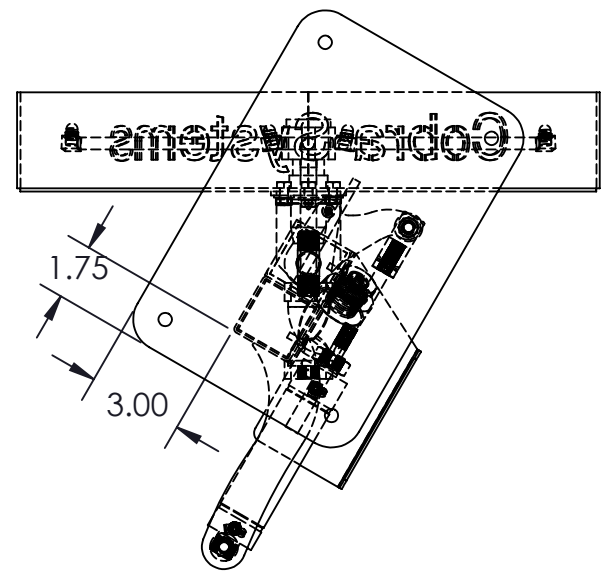
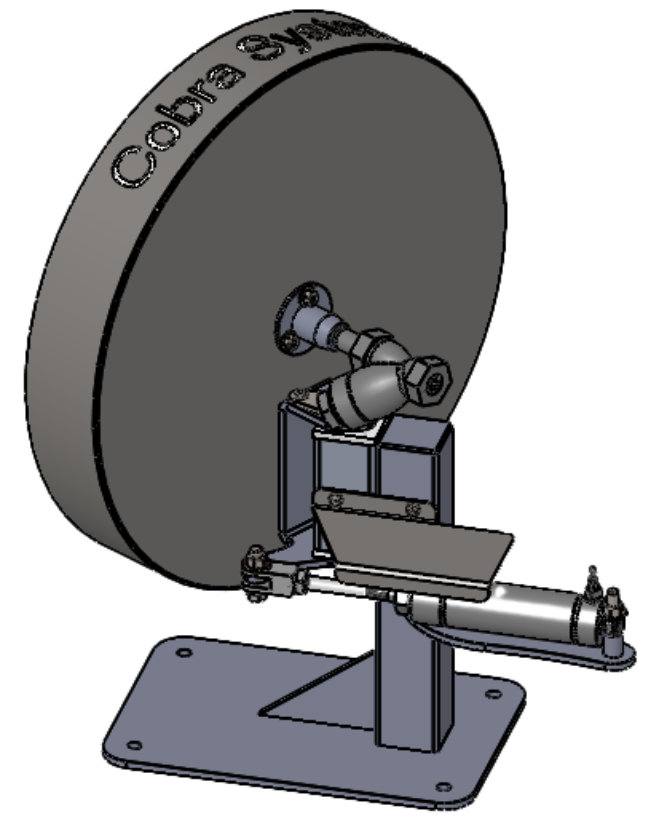
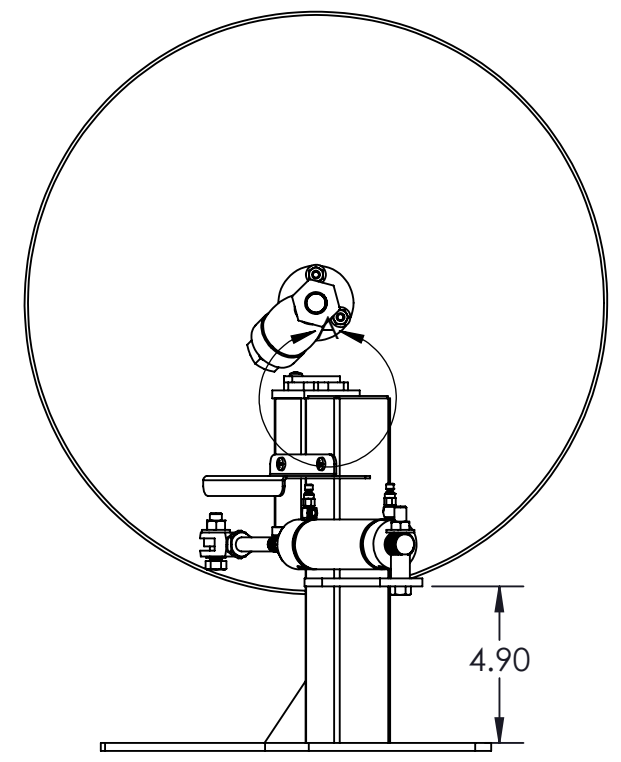
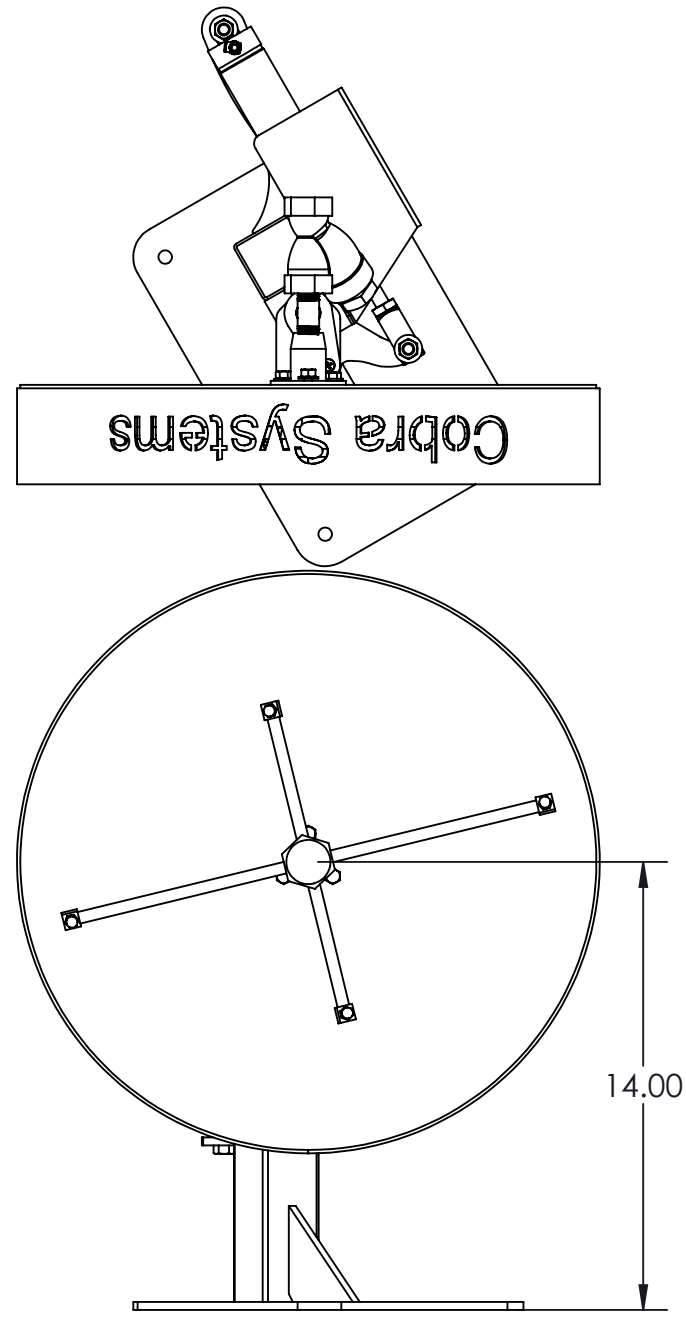

THE INFORMATION CONTAINED IN THIS DRAWING IS THE SOLE PROPERTY OF COBRA SYSTEMS. ANY REPRODUCTION IN PART OR WHOLE WITHOUT THE WRITTEN PERMISSION OF COBRA SYSTEMS IS PROHIBITED.

THIRD ANGLE PROJECTION	
NEXT ASSY	USED ON
APPLICATION	

UNLESS OTHERWISE SPECIFIED DIMENSIONS ARE IN INCHES TOLERANCES ARE:		CAD GENERATED DRAWING, DO NOT MANUALLY UPDATE	
FRACTIONS	DECIMALS	ANGLES	APPROVALS
+	.XX+ .03	+ 1°	DATE
	.XXX+.010		
MATERIAL	SS304	CHECKED	
FINISH		RESP ENG	
		MFG ENG	
		QUAL ENG	
DO NOT SCALE DRAWING			

The Cobra System
Heated Chemical Innovations

Wheel Blaster

SIZE B	DWG. NO. C-200	REV. 03
CAD FILE:		SHEET 1 OF 2

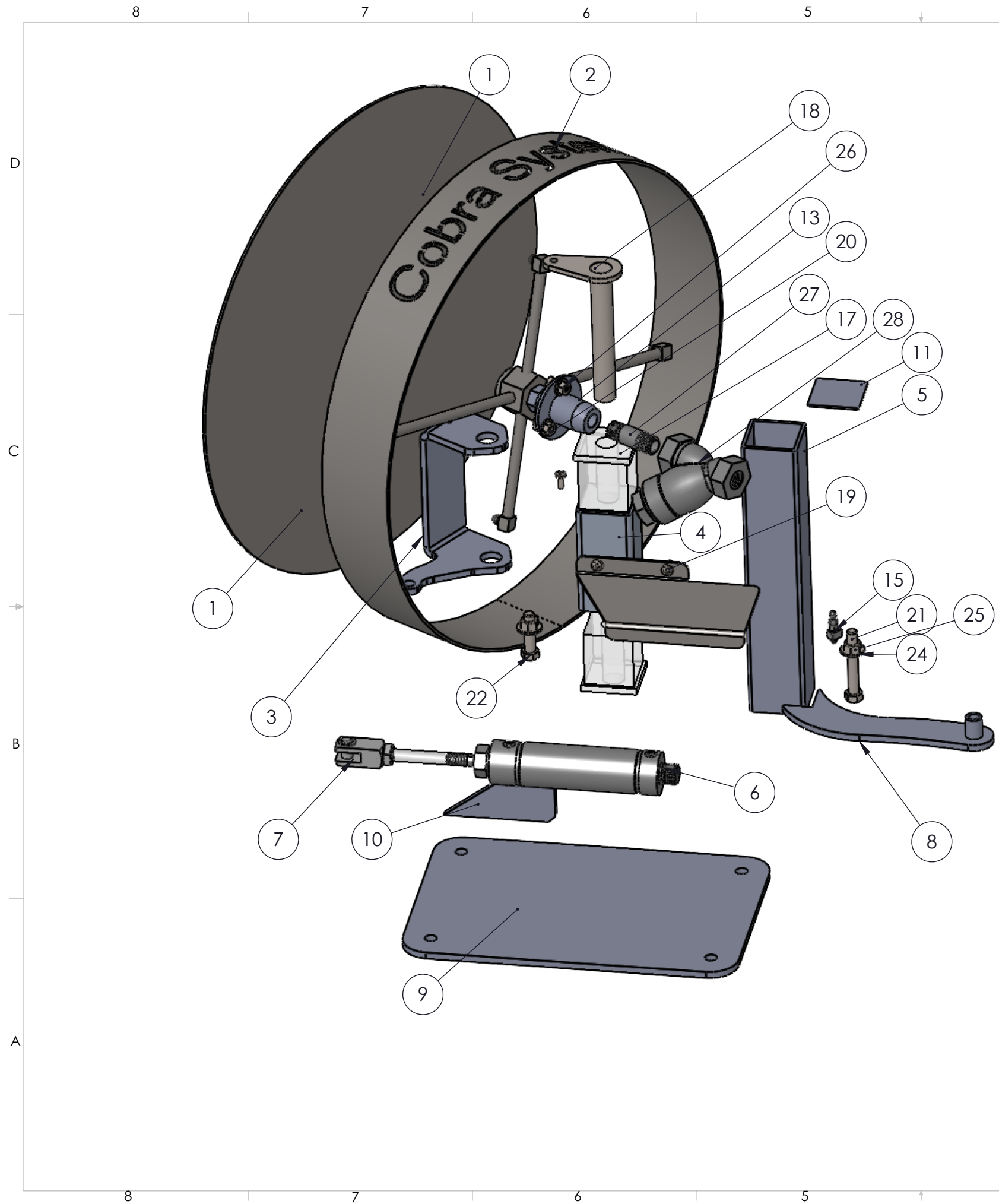

REVISIONS			
REV.	DESCRIPTION	DATE	APPROVED

ITEM NO.	PART NUMBER	DESCRIPTION	QTY.
1	C-201	Wheel Blaster Backplate Standard	1
2	C-202	Outside Ring Standard	1
3	C-203	Moving Hinge Bracket	1
4	C-204	Stationary Hinge Tube	1
5	C-205	Upright	1
6	C-230	Cushioned Air Cylinder	1
7	C-231	Cylinder Clevis	1
8	C-206	Stationary Cylinder Mount	1
9	C-207	Base	1
10	C-208	Base Support	1
11	C-209	Tube Cap	1
12	C-210	Cylinder Guard	1
13	C-211	Rotary Union 3/8" FNPT	1
14	C-212	Wand	1
15	C-213	Flow Control Valve	2
16	C-214	.125 Zero Degree Nozzle	4
17	C-108	Hinge Bushing	2
18	C-119	Hinge Pin	1
19	C-250	CR-BHMS 0.19-32x0.5x0.5-N	3
20	C-251	HBOLT 0.2500-20x0.5x0.5-N	3
21	C-252	HBOLT 0.3750-16x2.5x1-N	1
22	C-256	HBOLT 0.3750-16x1.5x1-N	1
23	C-253	Preferred Narrow FW 0.25	3
24	C-253	Washer	2
25	C-254	HNUT 0.3750-16-D-N	2
26	C-255	HNUT 0.2500-20-D-N	3
27	C-215	3/8 Nipple	1
28	C-216	SS y Strainer	1

THE INFORMATION CONTAINED IN THIS DRAWING IS THE SOLE PROPERTY OF COBRA SYSTEMS. ANY REPRODUCTION IN PART OR WHOLE WITHOUT THE WRITTEN PERMISSION OF COBRA SYSTEMS IS PROHIBITED.

THIRD ANGLE PROJECTION	
UNLESS OTHERWISE SPECIFIED DIMENSIONS ARE IN INCHES TOLERANCES ARE:	
FRACTIONS DECIMALS ANGLES	
+ .XX+ .03 + .1°	
.XXX+.010	
MATERIAL	SS304
FINISH	
NEXT ASSY	USED ON
APPLICATION	DO NOT SCALE DRAWING

CAD GENERATED DRAWING, DO NOT MANUALLY UPDATE	
APPROVALS	DATE
DRAWN SMD	4/30/23
CHECKED	
RESP ENG	
MFG ENG	
QUAL ENG	



Wheel Blaster

SIZE B	DWG. NO. C-200	REV. 03
CAD FILE:		SHEET 2 OF 2